

SAFETY, HEALTH AND ENVIRONMENTAL INFORMATION

In addition to the hazards/risks normally associated with the types of work detailed on this drawing, note the following:

CONSTRUCTION

MAINTENANCE/CLEANING

DECOMMISSIONING/DEMOLITION

It is assumed that all works will be carried out by a competent contractor working, where appropriate, to an approved method statement

KEY

POTENTIAL CONTAMINATION SOURCES

1 RAILWAY LAND

2 AGRICULTURAL LAND

3 TEXTILE FACTORIES

4 PLANTATION LANE LANDFILL

5 QUARRY

6 MOCHDRE INDUSTRIAL ESTATE

7 DYFFRYN INDUSTRIAL ESTATE

8 SEWAGE WORKS

9 FORMER ANIMAL SLAUGHTER HOUSE

10 TIPPING

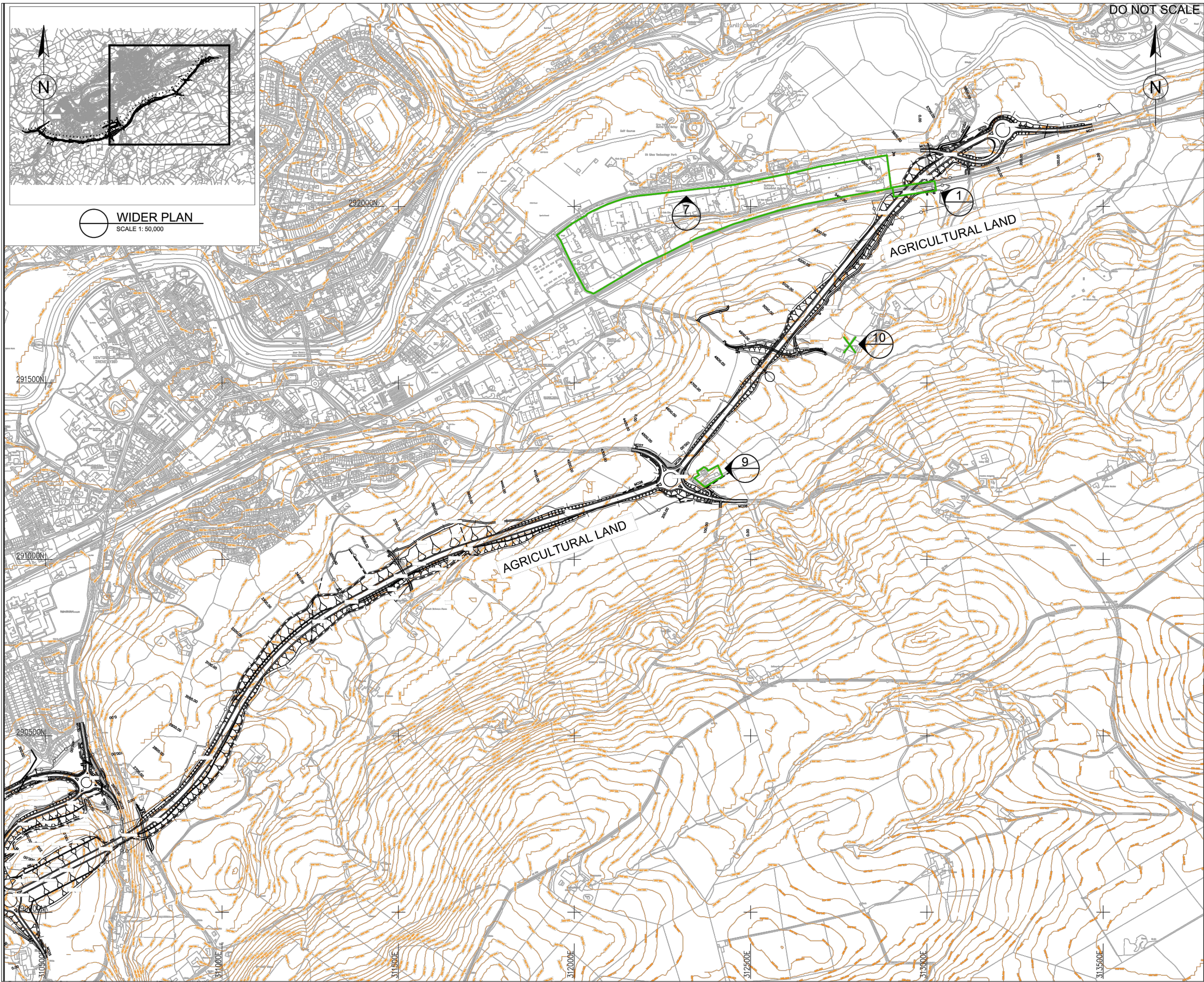

SAFETY, HEALTH AND ENVIRONMENTAL INFORMATION

In addition to the hazards/risks normally associated with the types of work detailed on this drawing, note the following:

CONSTRUCTION

MAINTENANCE/CLEANING

DECOMMISSIONING/DEMOLITION

It is assumed that all works will be carried out by a competent contractor working, where appropriate, to an approved method statement

KEY

POTENTIAL CONTAMINATION SOURCES

1 RAILWAY LAND

2 AGRICULTURAL LAND

3 TEXTILE FACTORIES

4 PLANTATION LANE LANDFILL

5 QUARRY

6 MOCHDRE INDUSTRIAL ESTATE

7 DYFFRYN INDUSTRIAL ESTATE

8 SEWAGE WORKS

9 FORMER ANIMAL SLAUGHTER HOUSE

10 TIPPING

© Crown Copyright and database right 2014. Ordnance Survey 100021874. Welsh Government.
© Hawlfraint a hawliau cronfa ddata'r Goron 2014. Rhif Trwydded yr Arolwg Ordnans 100021874.



Job Title

A483/A489
Newtown Bypass

Drawing Title

Environmental Statement
Geology and Soils
Potential Contamination Sources - Eastern Section
Sheet 2 of 2

Date	OCT 2014	Drawn by	JSD
Scale at A3	Not to Scale	Checked	DD
Drawing Status	FINAL	Approved	SW
Job No	60597	Figure No	9.1b
		Issue	-

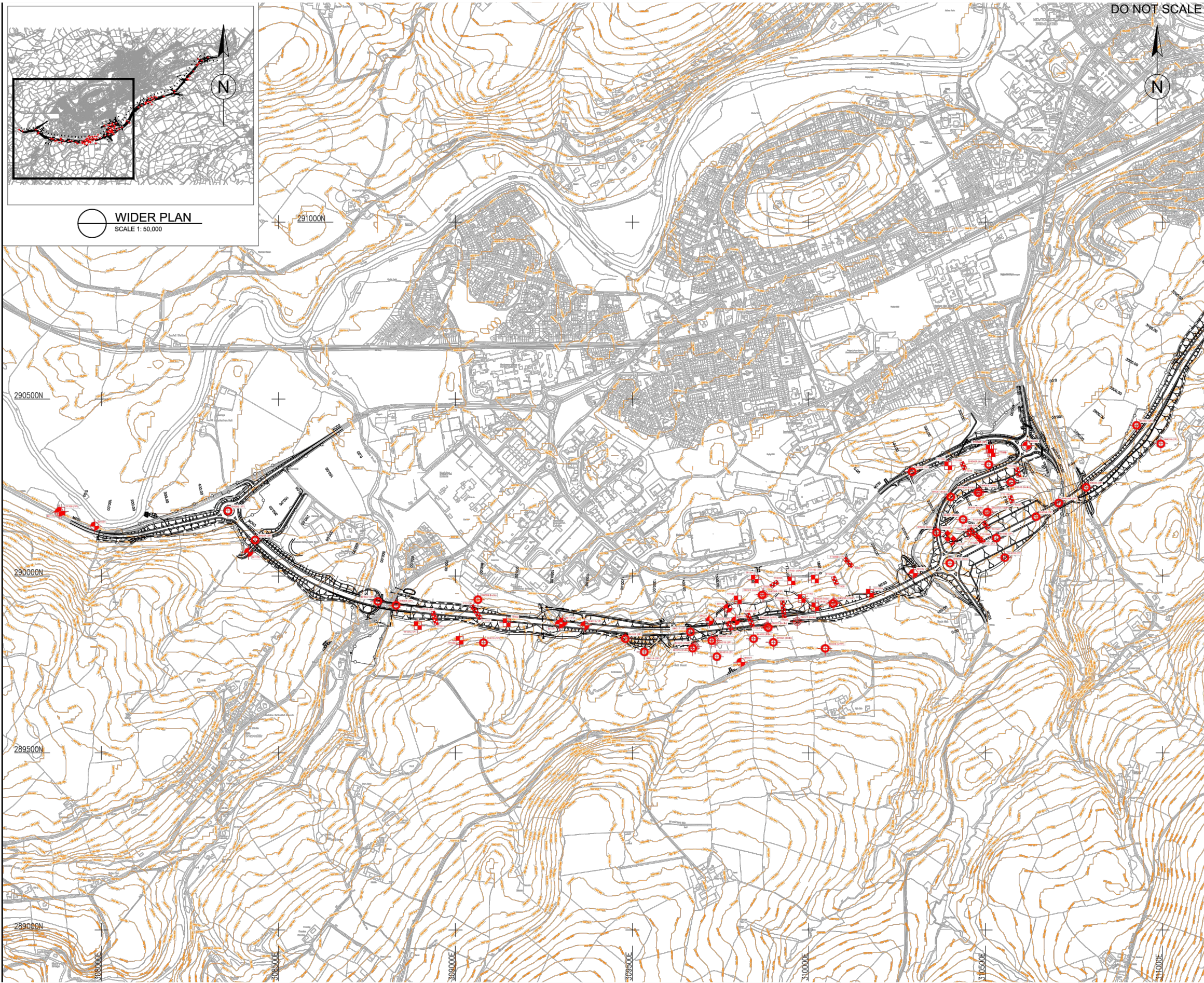

SAFETY, HEALTH AND ENVIRONMENTAL INFORMATION
In addition to the hazards/risks normally associated with the types of work detailed on this drawing, note the following:

CONSTRUCTION

MAINTENANCE/CLEANING

DECOMMISSIONING/DEMOLITION

It is assumed that all works will be carried out by a competent contractor working, where appropriate, to an approved method statement

NOTES

1. GI undertaken between 6th September 2013 and 20th December 2013.
2. Borehole and trial pit locations were surveyed in post-GI and therefore are accurately positioned.

KEY

- BOREHOLE LOCATIONS
- TRIAL PIT LOCATIONS

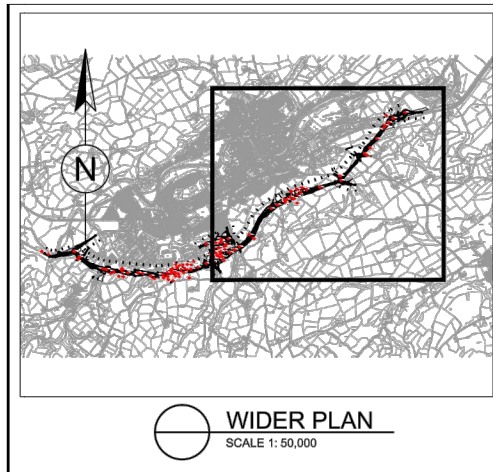

SAFETY, HEALTH AND ENVIRONMENTAL INFORMATION
In addition to the hazards/risks normally associated with the types of work detailed on this drawing, note the following:

CONSTRUCTION

MAINTENANCE/CLEANING

DECOMMISSIONING/DEMOLITION

It is assumed that all works will be carried out by a competent contractor working, where appropriate, to an approved method statement

- NOTES**
- GI undertaken between 6th September 2013 and 20th December 2013.
 - Borehole and trial pit locations were surveyed in post-GI and therefore are accurately positioned.

- KEY**
- BOREHOLE LOCATIONS
 - TRIAL PIT LOCATIONS

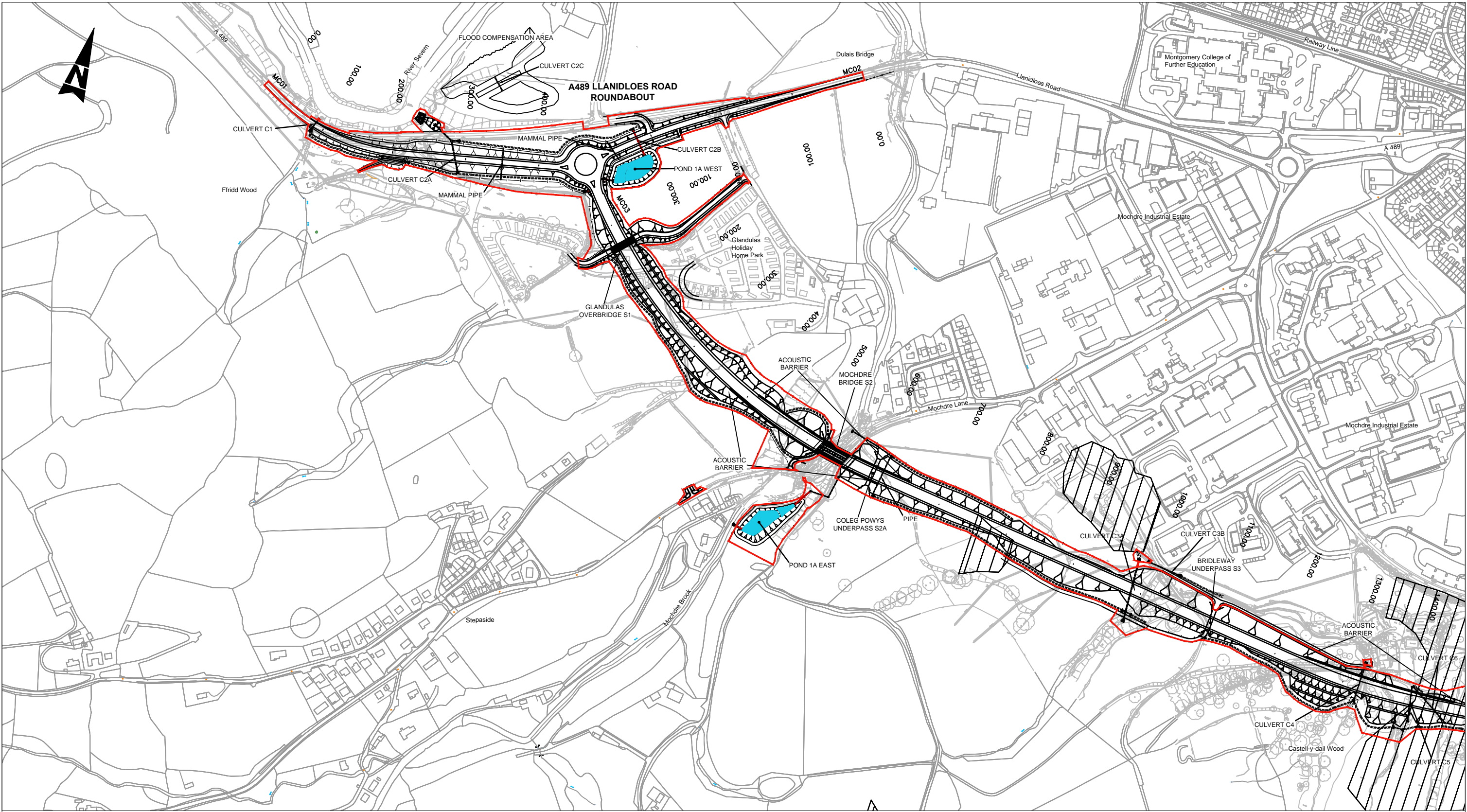

Geology and Soils

Relic Land Slip Areas

Site Extents Boundary

© Crown Copyright and database right 2014. Ordnance Survey 100021874. Welsh Government.
© Hawlfraint a hawliau cronfa ddata'r Goron 2014. Rhif Trwydded yr Arolwg Ordans 100021874.

Client/Team



Llywodraeth Cymru
Welsh Government



Job Title

A483/A489
Newtown Bypass

Drawing Title

Environmental Statement
Geology and Soils
Relic Land Slip Areas
Sheet 1 of 4

Date

OCT 2014

Drawn by

FS

Scale at A3
1:5,000

Scale at A1
1:2,500

Checked

MB

Drawing Status

FINAL

Approved

JW

Job No

60597

Figure No

9.3a

Issue

-

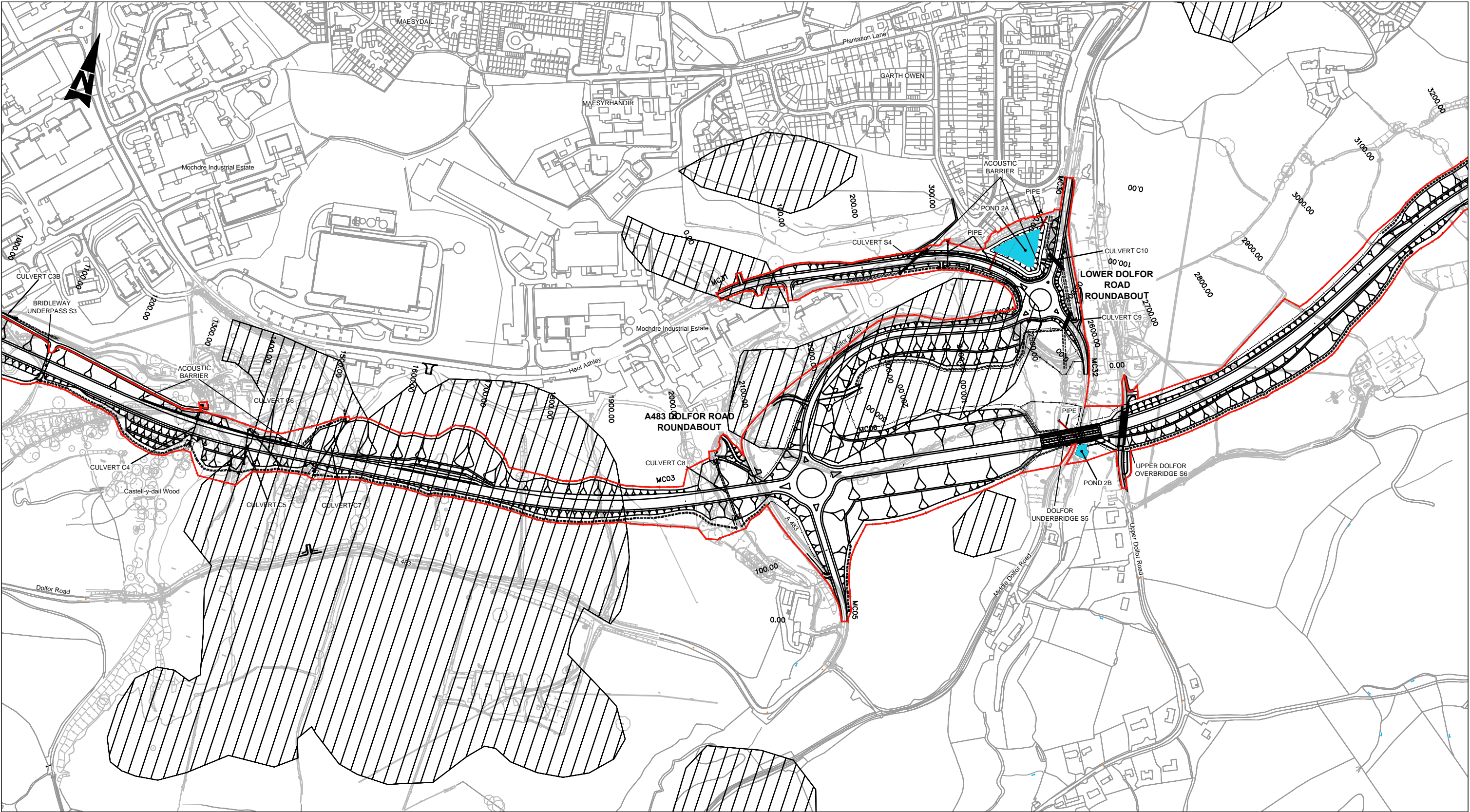

Geology and Soils

Relic Landslip Areas

Site Extents Boundary

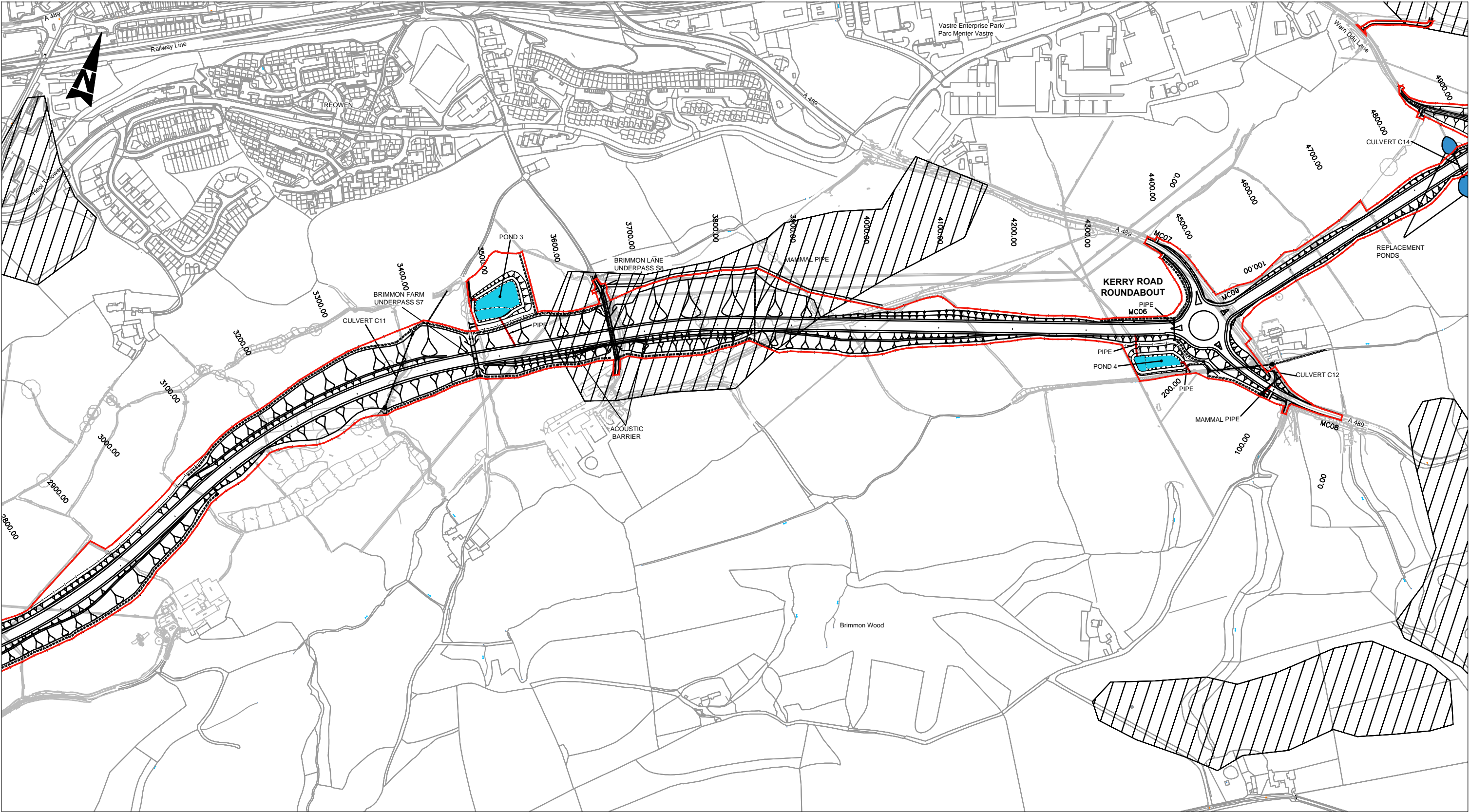

Geology and Soils

Relic Landslip Areas

Site Extents Boundary

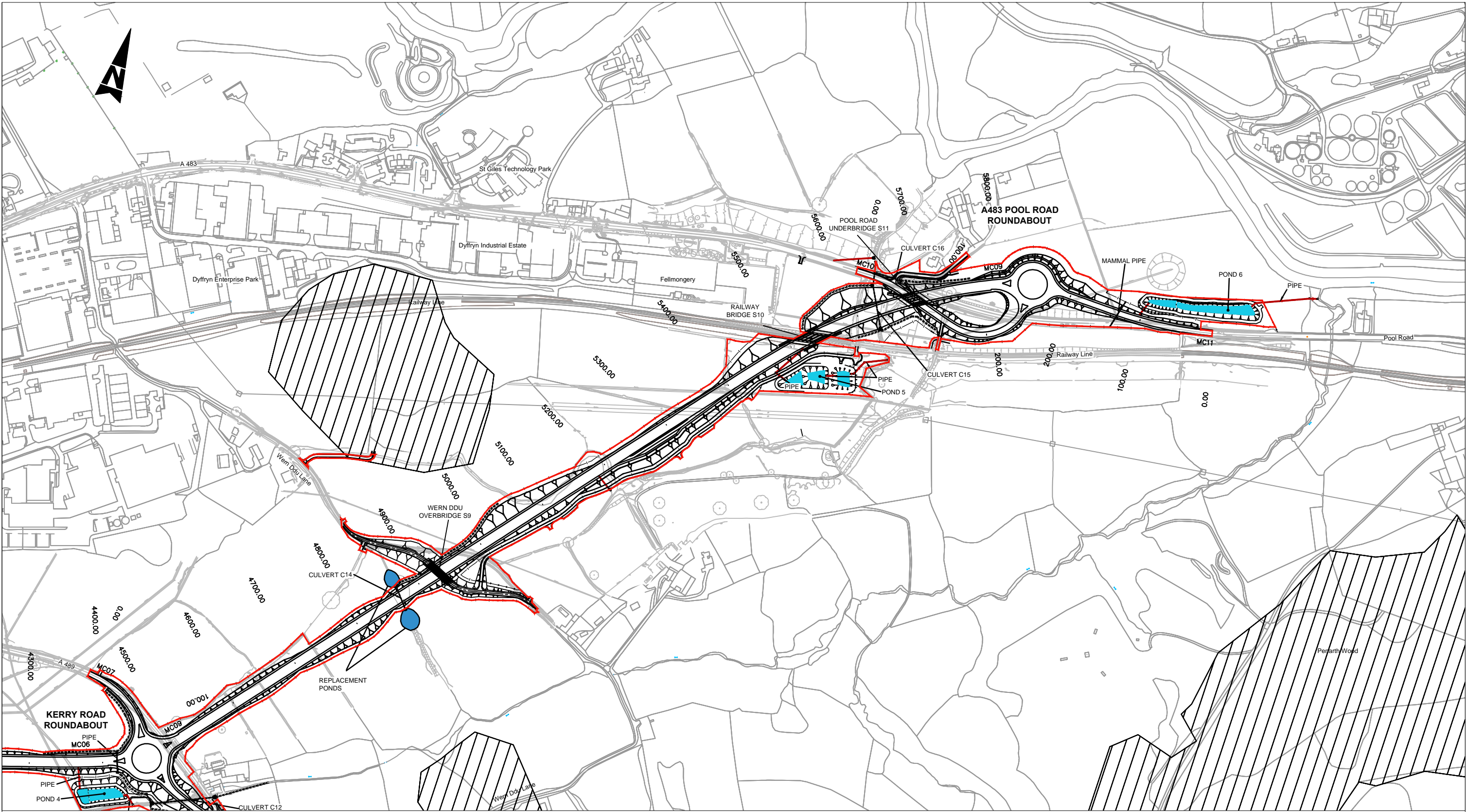

Geology and Soils

Relic Landslip Areas

Site Extents Boundary

© Crown Copyright and database right 2014. Ordnance Survey 100021874. Welsh Government.
© Hawlfraint a hawliau cronfa ddata'r Goron 2014. Rhif Trwydded yr Arolwg Ordans 100021874.

Client/Team

Llywodraeth Cymru
Welsh Government

civil engineering and construction

CORDEROY

CAPITA

Job Title

A483/A489
Newtown Bypass

Drawing Title

Environmental Statement
Geology and Soils
Relic Land Slip Areas
Sheet 4 of 4

Date	OCT 2014	Drawn by	FS
Scale at A3	1:5,000	Scale at A1	1:2,500
Drawing Status	FINAL	Checked	MB
Job No	60597	Approved	JW
Figure No	9.3d	Issue	-