

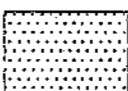

Victoria Wharf  
Glanfa Victoria

**Key**  
Allweddol

 Highway to be stopped up.  
Prifffordd yn cael ei chau.

 New highway.  
Prifffordd newydd.

SCALE 1:500  
GRADDFA 1:500

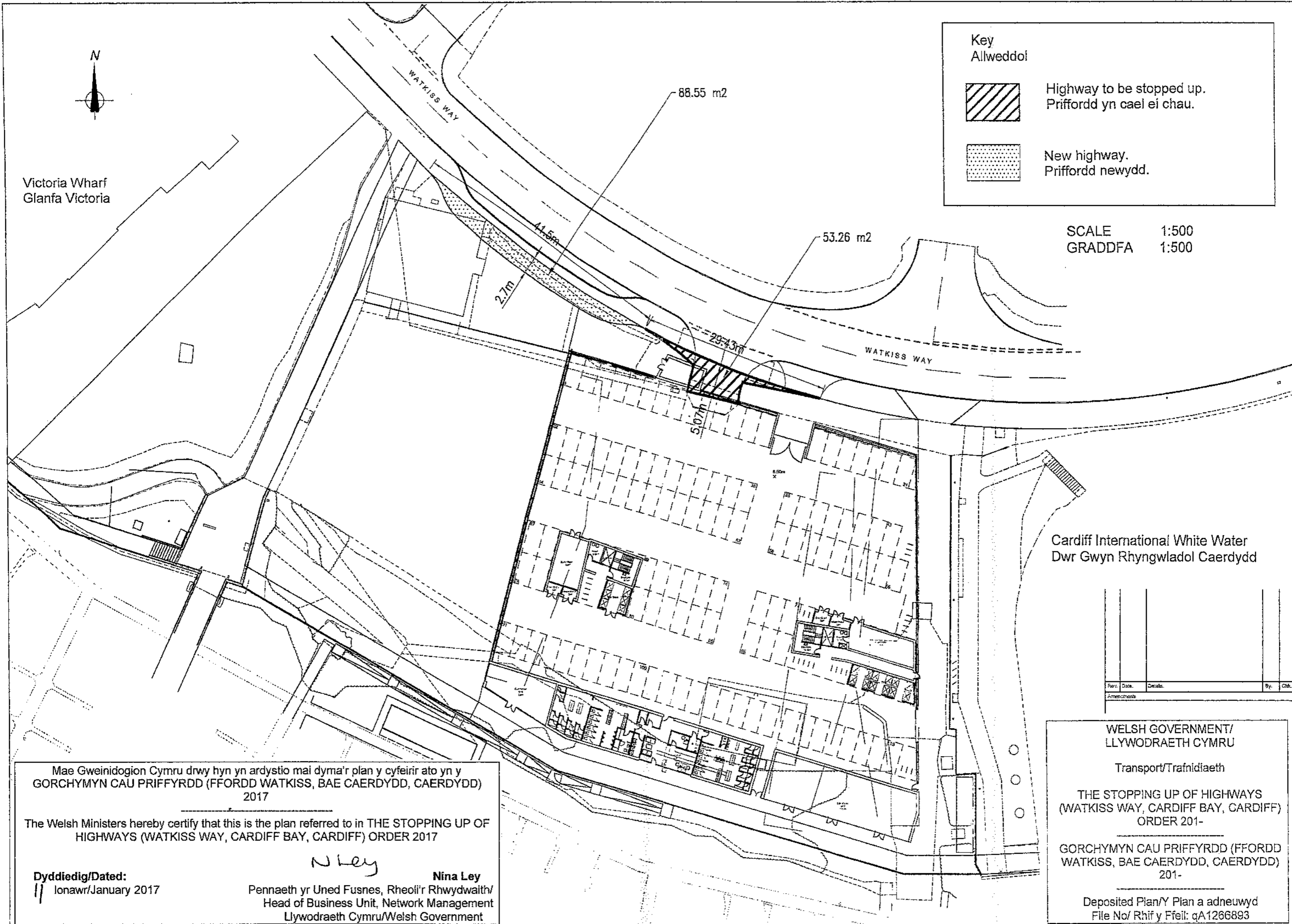

Cardiff International White Water  
Dwr Gwyn Rhyngwladol Caerdydd

Form	Date	Details	By	CHK.

Mae Gweinidogion Cymru drwy hyn yn ardystio mai dyma'r plan y cyfeirir ato yn y  
GORCHYMYN CAU PRIFFYRDD (FFORDD WATKISS, BAE CAERDYDD, CAERDYDD)  
2017

The Welsh Ministers hereby certify that this is the plan referred to in THE STOPPING UP OF  
HIGHWAYS (WATKISS WAY, CARDIFF BAY, CARDIFF) ORDER 2017

*N Ley*  
**Nina Ley**  
Pennaeth yr Uned Fusnes, Rheoli'r Rhwydwaith/  
Head of Business Unit, Network Management  
Llywodraeth Cymru/Welsh Government

**Dyddiedig/Dated:**  
11 Ionawr/January 2017

WELSH GOVERNMENT/  
LLYWODRAETH CYMRU

Transport/Trafnidiaeth

THE STOPPING UP OF HIGHWAYS  
(WATKISS WAY, CARDIFF BAY, CARDIFF)  
ORDER 201-

GORCHYMYN CAU PRIFFYRDD (FFORDD  
WATKISS, BAE CAERDYDD, CAERDYDD)  
201-

Deposited Plan/Y Plan a adnewydw  
File No/ Rhif y Ffeil: qA1266893