



COPYRIGHT  
 CARMARTHENSIRE COUNTY COUNCIL RETAINS COPYRIGHT OF THIS DRAWING.  
 This drawing must not be copied, reproduced or altered in any way, without the written permission of Carmarthenshire County Council.

DO NOT SCALE THIS DRAWING.  
 It is the contractor's responsibility to verify all dimensions on site prior to proceeding with the works. All figured metric dimensions are to be worked to wherever expressly annotated. Such dimensions, unless expressly noted otherwise, are to be taken as structural, and therefore due allowances should be made for plaster, finishes, etc.

Any discrepancies between drawings and the manifested site works are to be verified and cooperated with Carmarthenshire County Council before implementation.

READ ALL DRAWINGS AS ONE  
 Always ensure that the latest editions, or revisions, of ALL drawings are used at all times. If in doubt, please contact the allocated Carmarthenshire County Council person responsible for that project.

Drawings are to be read in conjunction with the latest editions, or revisions, of all other relevant details and schedules.

Where any contradiction or uncertainty arises between the drawings and / or the schedule of works, it is the contractor's responsibility to seek verification from Carmarthenshire County Council before proceeding. No claims will be met by Carmarthenshire County Council where the contractor continues work in absence of such confirmation.

NOT FOR SITE PURPOSES  
 This drawing is a general arrangement plan only, and is not intended for site purposes.

**Drawing Key :**

- Ffin y safle / Site Boundary
- Ffin y Prifffordd / Highway Boundary within approved site
- Prifffordd yn cael ei chau / Highway to be stopped up

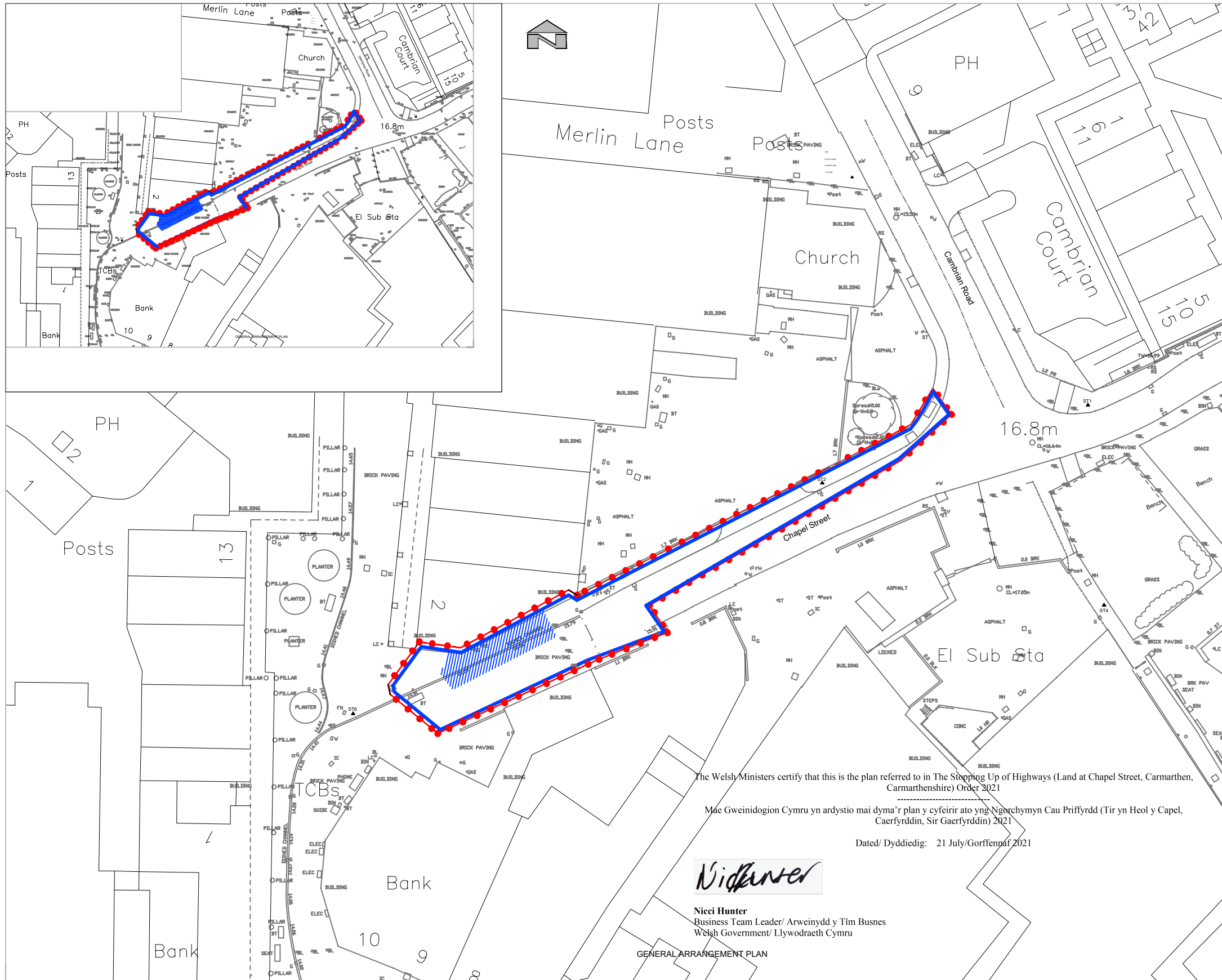

The Welsh Ministers certify that this is the plan referred to in The Stopping Up of Highways (Land at Chapel Street, Carmarthen, Carmarthenshire) Order 2021

Mae Gweinidogion Cymru yn ardstio mai dyma'r plan y cyfeirir ato yng Ngorchymyn Cau Prifffordd (Tir yn Heol y Capel, Caerfyrddin, Sir Gaerfyrddin) 2021

Dated/ Dyddiedig: 21 July/Gorffennaf 2021

*Nidhaner*

**Nicci Hunter**  
 Business Team Leader/ Arweinydd y Tim Busnes  
 Welsh Government/ Llywodraeth Cymru

GENERAL ARRANGEMENT PLAN

A		Amendment to key	02/2022
CLIENT & PLANNING ISSUE			
Details			
Number:	Amendment Details		Date
<b>INFORMATION</b>			
Drawing Title Stopping Up boundary			
From:	Scale: (to A3) Grids		
MC	<input type="checkbox"/> 1:1	<input type="checkbox"/> 1:2	
	<input type="checkbox"/> 1:5	<input type="checkbox"/> 1:10	
Date:	<input type="checkbox"/> 1:20	<input type="checkbox"/> 1:50	
Jan 2020	<input type="checkbox"/> 1:100	<input type="checkbox"/> 1:200	
Approved:	<input type="checkbox"/> 1:500	<input type="checkbox"/> 1:1000	
	<input type="checkbox"/> 1:1250	<input type="checkbox"/> 1:2500	
Client / Sponsor: Carmarthenshire County Council			
Drawing Number: CCC-A-SK-02-A			
Ruth Mullen, BSc Cefnddwiler Yr Amgylchedd Director of Environment © 2018 Carmarthenshire County Council DN-F-001 1:00 01-04-18			
H. Harries, M.B.I.C.S. Rheolwr Dylunio Eiddo Property Design Manager Block 3, Parc Myrddin, Richmond Terrace Carmarthen, Carmarthenshire, SA31 1HQ Tel: 01267 228370			

**Stopping up Boundary**

**Note : Drawing reproduced from existing drawing JSL-CAP-01-S1-DR-C-103. Boundary of stopping up notice confirmed by sponsor.**

